

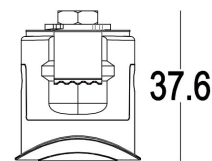

POD 32 LED Handrail Light

- Compact appearance design
- High strength die-cast aluminium housing
- Adopts the anti-theft design fixed by rotation
- Self-contained stainless steel bracket
- Optical dark-free zone design for seamless splicing of light
- International standard DMX512 protocol
- Waterproof IP66 rating
- Osram LED's

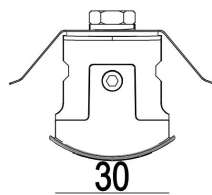
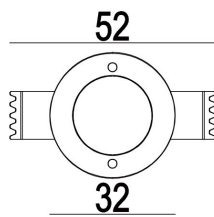

POD 32 LED Handrail Light



- Power Consumption 2W
- Input Voltage DC24V
- IP Rating IP66 / IK Rating IK08
- Luminous Flux 150 lm @4000K
- Color Temperature 2700K / 3000K / 4000K / 5000K / 5700K / 6500K
- Beam Angle (50%Imax) 50*80
- Operating Temperature -35°C ~ 60°C(-31°F ~ 140°F)
- Storage Temperature -40°C ~ 70°C(-40°F ~ 158°F)
- Certificate CE / RoHS / EMC
- Protection Class IEC III

Light Distribution Curve

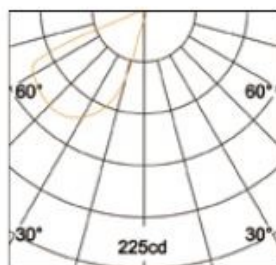

H(m)	E(lx)	D(m)	
		Co	Ca
		90°	50°
1	117	1.68	0.93
2	29	3.36	1.87
3	13	5.03	2.80
4	7	6.71	3.73
5	5	8.39	4.66

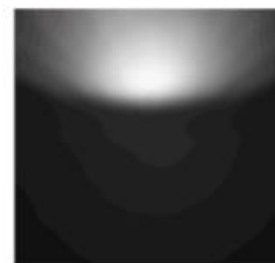

POD 32 LED Handrail Light**Specification**

Power Consumption	2W
Luminous Flux	130 lm @4000K
Colour Temperature	2700K / 3000K / 4000K / 5000K / 5700K /
Beam Angle	(50%Imax) 55*70°
LED Brand	CREE / NICHIA / OSRAM / LUMILEDS
Input Voltage	DC24V
Protection	Class IEC III
Control	ON-OFF
Finish	Anti-corrosion treatment and high-temperature spraying
Housing	Die-cast aluminum ADC12
Cover	PC
IP Rating	IP66
IK Rating	IK08
Mounting	Recessed
Operating Temperature	-35°C ~ 60°C(-31°F ~ 140°F)
Storage Temperature	-40°C ~ 70°C(-40°F ~ 158°F)
Lifespan	>50,000Hrs(Ta=35°C@L70)
Certificate	CE / RoHS / EMC

Contact us for a quote or for more information: sales@lightrail.net.au



POD 32 LED Installation

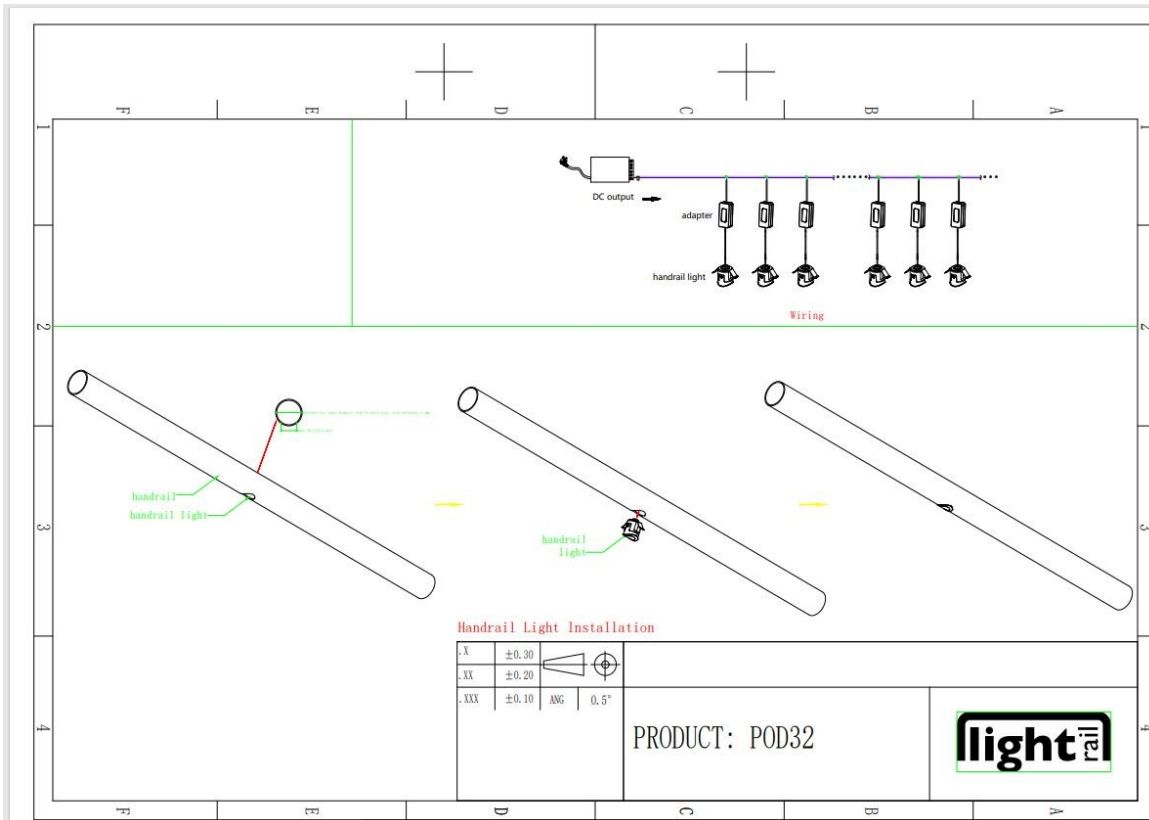

POD 32 LED Handrail Light maintenance

- Easy maintenance using Lightrail POD removal tool
- Supplied separately

